



# Professional CCTV System 1080P 4 IN 1 Camera

## User Manual



Please Read This User Guide Carefully Before Use.



## Warning



To prevent fire or electric shock hazard, .  
Only use specified power supply

## CONNECTING CCTV SYSTEM

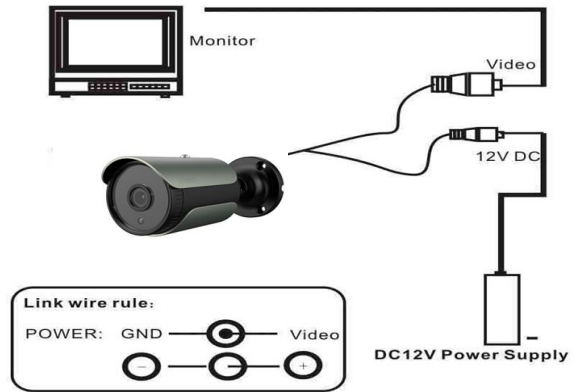

## Specification

Model	XY-AHD771BVF 1080P 4IN1
Sensor	1080P CMOS Image Sensor
System	PAL
Picture Elements	PAL:1920(H)*1080(V)
Horizontal Recolution	2.0 Megapixel
Video OutPut	<b>Hybrid Video Output</b>
S/N Ratio	≥48dB
Min.Illumination	0.05LUX(without IR LED)
Electronic Shutter	1/50(1/60)S~1/100,000S
White Balance	Auto
Gamma Ratio	>0.45
Lens Mount	2.8~12mm 2MP lens
Operating Temp.	-10°C ~ +50°C
Humidity	0 to 95%RH(non-condensing)
Power/Current	DC 12V
Sync System	2:1 Interlace internal Sync.
OSD Language	English
Night vision	40M / 42 units IR LED
Outdoor/Indoor	Outdoor

## Packing list

Name	Model	Number
Digital CCTV Camera	XY-AHD771BVF 1080P 4IN1	1
User Manual	XY-AHD771BVF 1080P 4IN1	1

## Changing the Setting on 4 in 1 camera

Hold button for 5 seconds according to table below to change setting.

Once set, remove power - Unit will now remain on new setting.

DIRECTION	UP	DOWN	LEFT	RIGHT
VIDEO	AHD	CVI	TVI	ANALOGUE(CVBS)

**Note: Camera default setting is AHD.**

### Method to change to TVI:

Hold button to LEFT for approx 5 sec, (no need to press button down), camera will switch to TVI, pull out power from camera, camera will remain set to TVI.

### Method to change to Analog (CVBS):

Hold button to RIGHT for approx 5 sec, camera will switch to Analog, pull out power from camera, camera will remain set to Analog.

### Method to change to CVI:

Hold button to DOWN for approx 5 sec, camera will switch to CVI, pull out power from camera, camera will remain set to CVI.



## Notes:

- \*Please Please note the camera's operating temperature and its working environment. Avoid using the camera at too high or too low temperatures.
- \*Never install the camera facing the direct sunlight or bright object. otherwise damage to the CCD will occur.
- \*Dont mount the camera near a radiator or heater.