

CARE AND MAINTENANCE

保養方法

- The torque screwdriver is a precision instrument and should be stored with care. Don't throw it around, use hammer with it.
- The torque screwdriver is lubricated for life and should not be oiled.
- After using the torque screwdriver please remember to adjust the torque scale to the zero and store in the box.
- The torque screwdriver is a precision measuring instrument. Calibration must be done regularly to ensure accuracy and it's the owner's responsibility.. Suggested calibration period is at least every year or even shorter depending on situation.
- Never disassemble the torque screwdriver by yourself. For any need to disassemble the torque screwdriver or repair it, please look for assistance form qualified service station.
- 扭力起子是精密的儀器，須妥善存放，禁止隨意扔擲或配合鐵鎚使用。
- 扭力起子出廠時已有使用潤滑油潤滑其零件，不應再自行上油。
- 使用後請將刻度降至最低點，以保持工具精準度並放回吹氣盒內歸位。
- 專業級扭力起子是精密的儀器，建議至少每年校驗一次，以保持其精準度。如經常性使用則須不定期重新校驗。
- 請勿自行拆解工業級扭力起子，如須拆解或維修請尋找專業的品質認證服務站進行協助。

STANDARD

標準

- We calibrate each torque screwdriver at the factory using torque standards according to DIN ISO 6789 & ASME B107.300-2010. and certifies it meets the accuracy requirements of specifications DIN ISO 6789 & ASME B107.300-2010.
- ◆ 測試標準根據 DIN ISO 6789 及 ASME B107.300-2010 來檢驗，以確保每支扭力起子的品質及精密度都符合上述國際標準之要求。

CONVERT FROM	TO	MULTIPLY BY
ozf-in	lbf-in	0.0625
lbf-in	ozf-in	16
lbf-in	kgf-cm	1.1519
lbf-in	lbf-ft	0.083333
lbf-in	kgf-m	0.011519
lbf-in	N-m	0.1130
lbf-in	dN-m	1.130
lbf-ft	N-m	1.356
lbf-ft	kgf-m	0.1382
lbf-ft	lbf-in	12
N-m	dN-m	10
N-m	kgf-cm	10.20
N-m	kgf-m	0.10197
N-m	lbf-in	8.8507
N-m	lbf-ft	0.73756
dN-m	lbf-in	0.885
dN-m	N-m	0.100
kgf-cm	lbf-in	0.8681
kgf-cm	N-m	0.09807
kgf-m	lbf-ft	7.233
kgf-m	N-m	9.807

Pro'sKit®

TORQUE SCREWDRIVER INSTRUCTION MANUAL

專業級扭力起子說明書

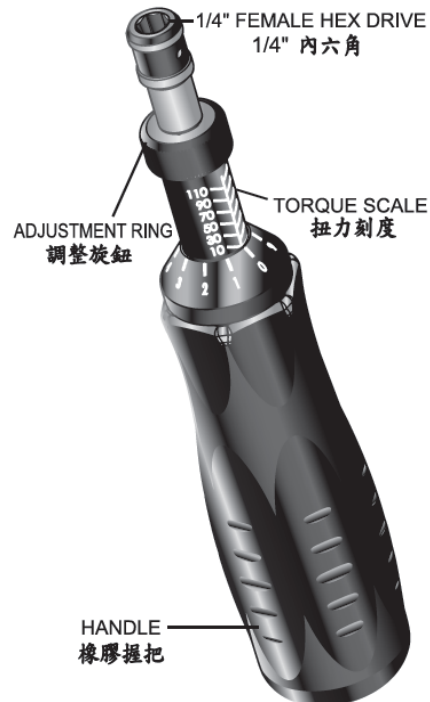

OPERATION 操作說明

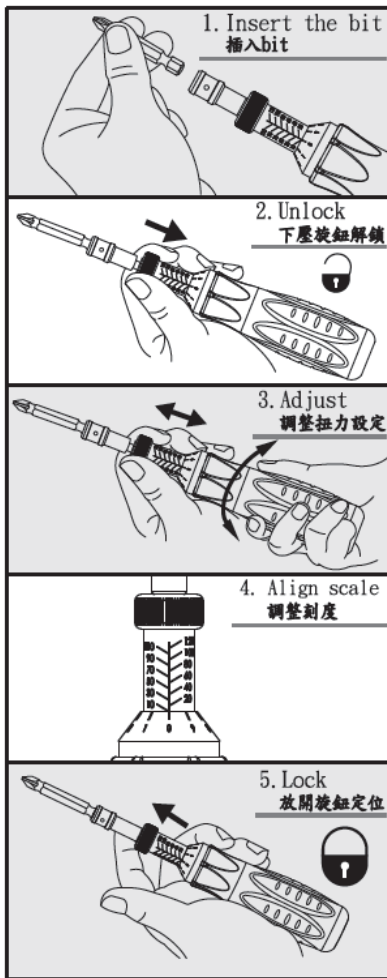

SAFETY INSTRUCTIONS

重要安全指示



WARNING

RISK OF FLYING PARTICLES

- DO NOT USE TORQUE SCREWDRIVER FOR LOOSENING.
- USE OF DAMAGED HAND TOOLS, SOCKETS, EXTENSIONS AND ACCESSORIES MAY RESULT IN INJURY.
- DO NOT USE TORQUE SCREWDRIVER AS A HAMMER.
- PREVENT TORQUE SCREWDRIVER DROPPING FROM HIGH PLACE.
- NEVER USE TORQUE SCREWDRIVER TO BREAK LOOSE FASTENERS.
- TORQUE SCREWDRIVER NOT IN CALIBRATION MAY CAUSE DAMAGE TO PARTS OR TOOLS.
- DO NOT USE EXTENSIONS ON HANDLE AS DAMAGE TO TORQUE SCREWDRIVER WILL RESULT.
- TO AVOID A "SIDE LOAD" OCCURRED WITH INACCURATE TORQUE READINGS, PLEASE KEEP TORQUE SCREWDRIVER VERTICAL TO THE FLAT OF USE.



ALWAYS USE EYE PROTECTION WHILE USING HAND TOOLS



INJURY MAY RESULT FROM ELECTRICAL SHOCK

• HANDLE IS NOT INSULATED. DO NOT USE ON LIVE ELECTRICAL OR HIGH VOLTAGE CIRCUITS.



注意事項!!

- ◆ 請勿將專業級扭力起子當做拆卸工具或鐵鏈使用。
- ◆ 請避免扭力起子從高處落下。
- ◆ 請勿將已損壞的工具或配件使用在專業級扭力起子上，以避免造成身體上的傷害。
- ◆ 請遵守標準的操作方式來使用專業級扭力起子，以避免零件及扭力起子損壞。
- ◆ 請勿將延長桿等延伸(長)工具裝置在膠握把上，以避免專業級扭力起子損壞及使用者受到傷害。
- ◆ 避免單邊施加扭力或未對準刻度使用，操作時請垂直平均施力，聽到"卡搭聲"即表示扭力到達，請勿再加以施力以避免造成螺絲及零件的損壞。



因橡膠握把並非絕緣的材質，因此禁止在漏電及高壓電的環境中使用，以免造成觸電或受傷。



在使用工具時，敬請隨時配帶護目鏡。

Pro'sKit[®] 

寶工實業股份有限公司
PROKIT'S INDUSTRIES CO., LTD.

<http://www.prokits.com.tw>

E-mail: pk@mail.prokits.com.tw