

TOP VIEW

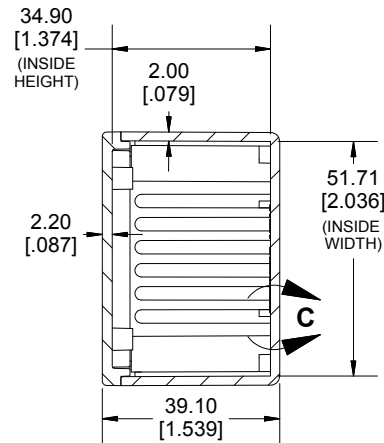

SECTION A-A

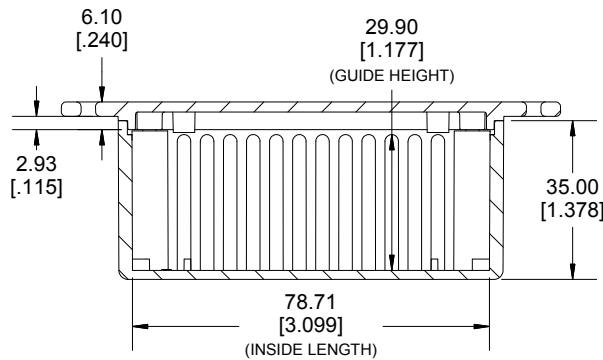
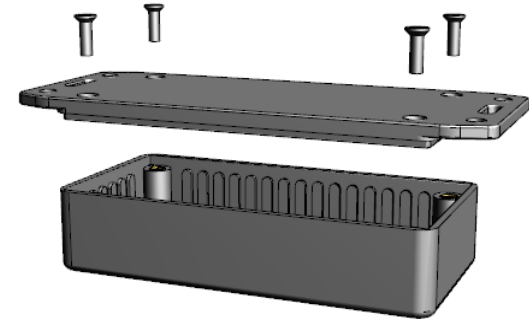

SECTION B-B  
SIDE VIEW

DETAIL C

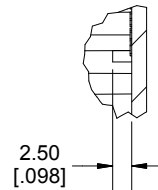

DETAIL D

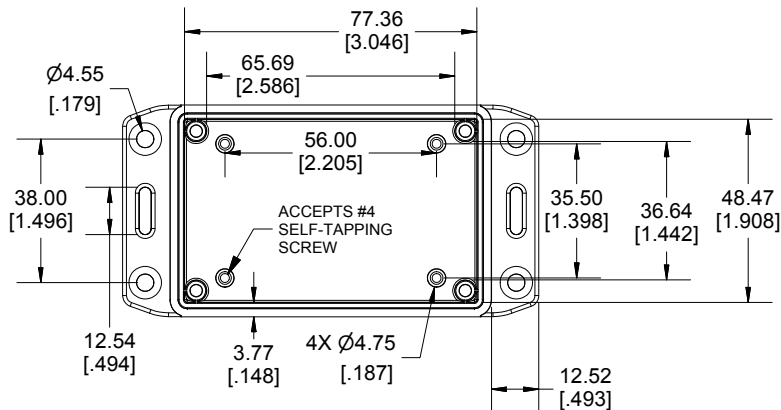
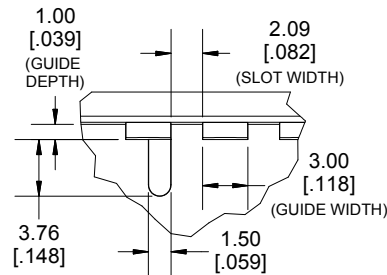

INSIDE LID

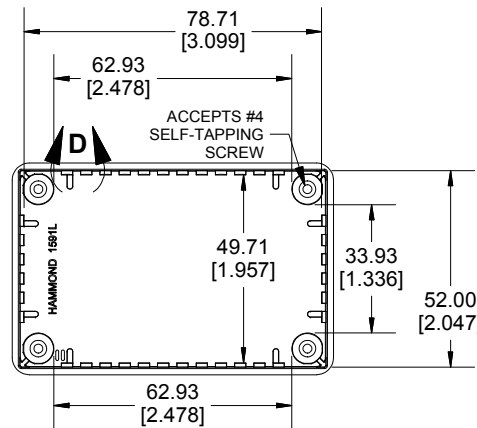

INSIDE BOX

Dimensions:  
mm  
[inches]

Enclosures can be Factory Modified (Milling, Drilling, Printing etc.)  
Contact Factory (modshop@hammondmg.com) for quotes  
Solid models of this enclosure available in STEP or PARA.  
(Part number and text placement/orientation on our products are subject to change,  
we do not recommend using them as a locating reference for modification purposes)

#### NOTE

Purchased assembly includes box, lid and 4 cover screws  
Enclosure made from GPABS.

**Recommended Torque: 42-57 ozf.in (30-40 cN.m)**

#### PART NUMBERS

1591L Enclosure	
General Purpose ABS Black	1591LSFLBK
Accessories	
Plated Cover screw	1591TS100 (Silver)
#4 X 1/2" (100Pkg) Self-Tapping	1591TS100BK (Black)
P.C Board screws for Lid	1593ATS50 (50Pkg)
#4 X 1/4" (6.4mm) Self-Tapping	1593ATS100 (100Pkg)
PC Board Card Adapters	1591Z6 (6Pkg)
	1591Z50 (50 Pkg)
	1591Z100 (100Pkg)
Nylon Belt / Pocket clip	1599CLIP (Black)
	1599CLIPGY (Grey)

**HAMMOND MANUFACTURING®**  
**1591LSFL**  
www.hammondmg.com