

Solid State Relay

KSI(068) Series Single Phase AC Output



- With IP20 Touch-Safe Cover
- Zero Switching or Random-on
- Output Current:25A,40A,60A,80A
- Load Voltage: 48-280VAC,48-440VAC, 48-530VAC or 48-660VAC
- SCR output
- Dielectric Strength 4000VACrms
- Internal RC/MOV and TVS protection

Product Description

KSI(068) series industrial single phase relay with IP20 touch-safe cover is the most widely used in industry application. The relay can be used for resistive, inductive and capacitive loads. The control input voltage is 4-32VDC or 90-280VAC, output current rate 25A, 40A, 60A, 80A @ 48-660VAC.

Product Selection

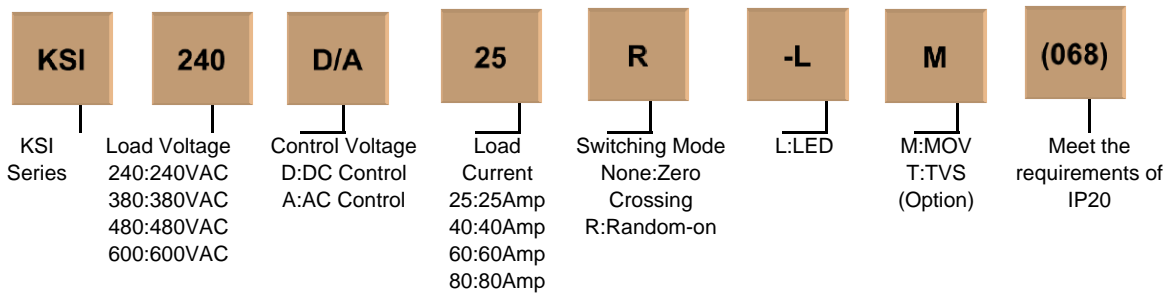

Description	25A	40A	60A	80A
D:4-32VDC	KSI240D25-L(068)	KSI240D40-L(068)	KSI240D60-L(068)	KSI240D80-L(068)
	KSI240D25R-L(068)	KSI240D40R-L(068)	KSI240D60R-L(068)	KSI240D80R-L(068)
	KSI380D25-L(068)	KSI380D40-L(068)	KSI380D60-L(068)	KSI380D80-L(068)
	KSI380D25R-L(068)	KSI380D40R-L(068)	KSI380D60R-L(068)	KSI380D80R-L(068)
	KSI480D25-L(068)	KSI480D40-L(068)	KSI480D60-L(068)	KSI480D80-L(068)
	KSI480D25R-L(068)	KSI480D40R-L(068)	KSI480D60R-L(068)	KSI480D80R-L(068)
	KSI600D25-L(068)	KSI600D40-L(068)	KSI600D60-L(068)	KSI600D80-L(068)
	KSI600D25R-L(068)	KSI600D40R-L(068)	KSI600D60R-L(068)	KSI600D80R-L(068)
A:90-280VAC	KSI240A25-L(068)	KSI240A40-L(068)	KSI240A60-L(068)	KSI240A80-L(068)
	KSI380A25-L(068)	KSI380A40-L(068)	KSI380A60-L(068)	KSI380A80-L(068)
	KSI480A25-L(068)	KSI480A40-L(068)	KSI480A60-L(068)	KSI480A80-L(068)
	KSI600A25-L(068)	KSI600A40-L(068)	KSI600A60-L(068)	KSI600A80-L(068)

Technical Specification

Input Circuit

Control Voltage Range	DC Input	4-32VDC
	AC Input	90-280VAC

Minimum Turn-On Voltage	DC Input	4VDC
	AC Input	90VAC
Minimum Turn-Off Voltage	DC Input	1VDC
	AC Input	10VAC
Maximum Input Current	DC Input	25mA
	AC Input	15mA
Output Circuit		
Load Voltage Range	240VAC	48-280VAC
	380VAC	48-440VAC
	480VAC	48-530VAC
	600VAC	48-660VAC
Maximum Turn-On Time	DC Input Random-On	1ms
	DC Input Zero-On	1/2AC Cycle + 1ms
Maximum Turn-Off Time	AC Input	40ms
	DC Input	1/2AC Cycle + 1ms
	AC Input	40ms
	DC Input	1/2AC Cycle + 1ms
Maximum Surge Current [@10ms]	25A	260A
	40A	360A
	60A	650A
	80A	1000A
Maximum I ² t For Fusing [@10ms]	25A	338A ² S
	40A	648A ² S
	60A	2210A ² S
	80A	5000A ² S
Transient Overvoltage	240VAC	600Vpk
	380VAC	800Vpk
	480VAC	1200Vpk
	600VAC	1600Vpk
Maximum Off-State Leakage Current [@ Rated Voltage]		5mA
Maximum On-State Voltage Drop [@ Rated Current]		1.6Vrms
Minimum Off-State dv/dt [@ Maximum Rated Voltage]		500V/μs
General Information		
Dielectric Strength[50/60Hz]	Input/Output	≥4000Vrms
	Output/Base	≥2500Vrms
Ambient Operating Temperature Range		-30°C ~ +80°C
Ambient Storage Temperature Range		-30°C ~ +100°C
Weight [Typical]		100g

Application

High-low Temperature Chamber, Plastics Machinery, Incubation Machine, Oiling Machine, HVAC, Elevator, Lighting, Fountain Controller.

Installation

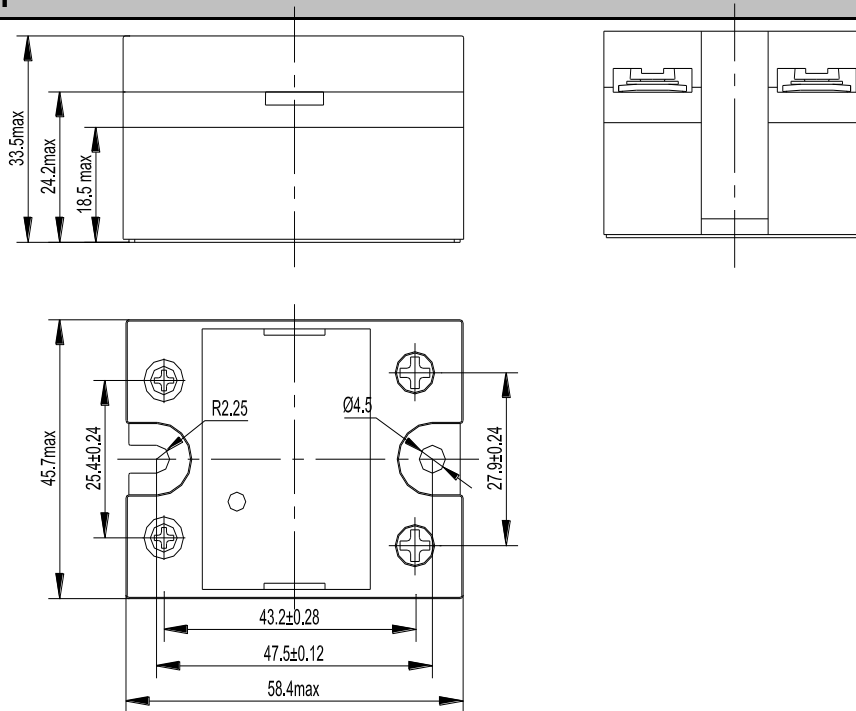

Thermal Curve

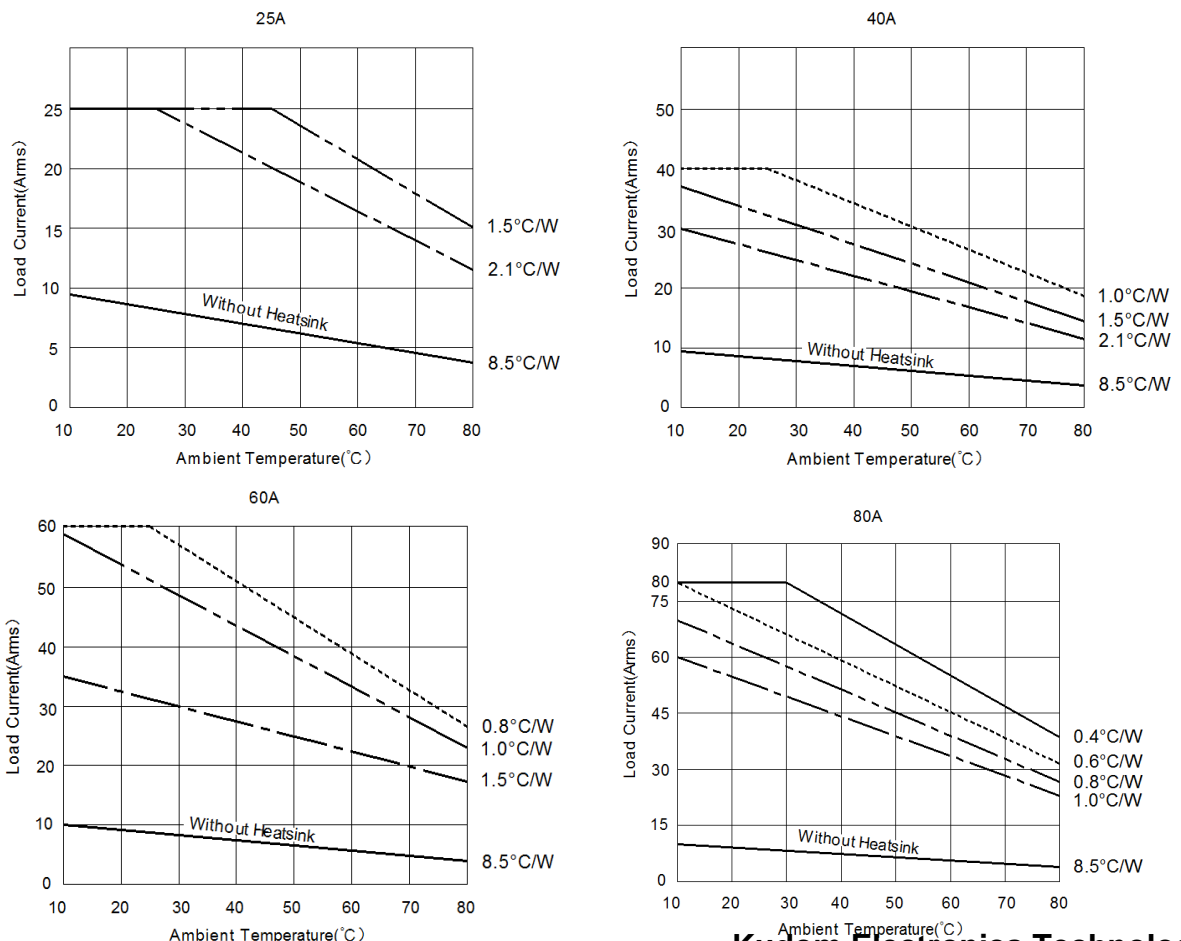

Important Notice

1. When the ambient temperature is over 40°C or many KSI(068)series are installed closely together, the user should take load discount into account according to the thermal curve.

Product Certification



@Kudom Electronics Technology, All Right Reserved