

Fire-alarm

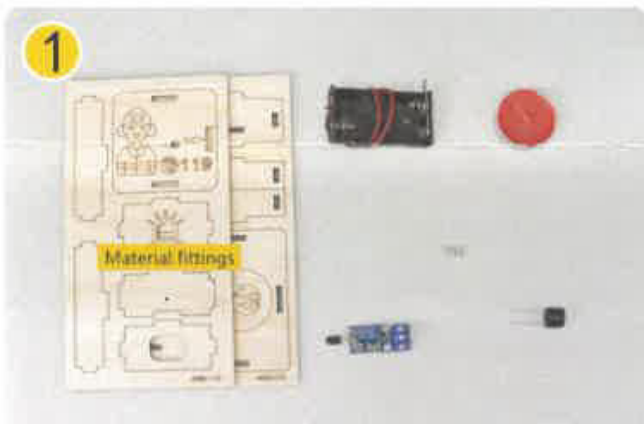

1. Know the parts. (Screwdriver, wire stripping tool)

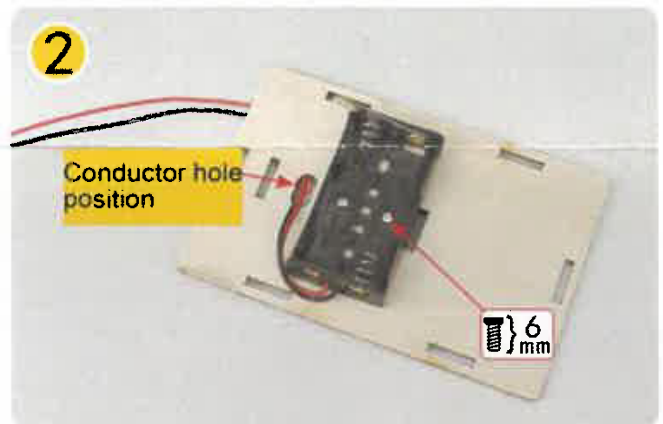

2. Secure the battery case with 6mm screws, then thread the wire through the round hole



3. Assemble the base.

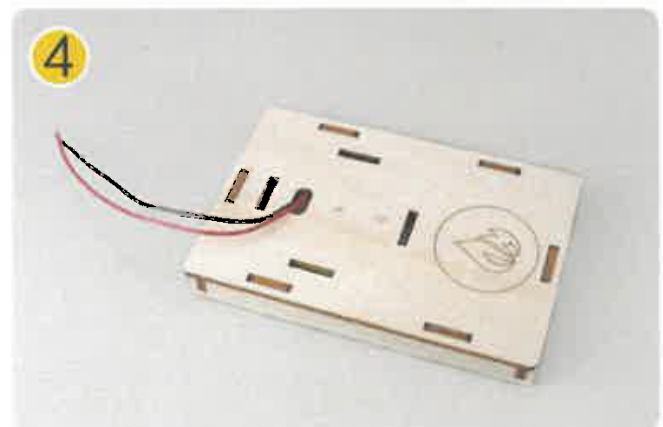

4. Fix the cover plate

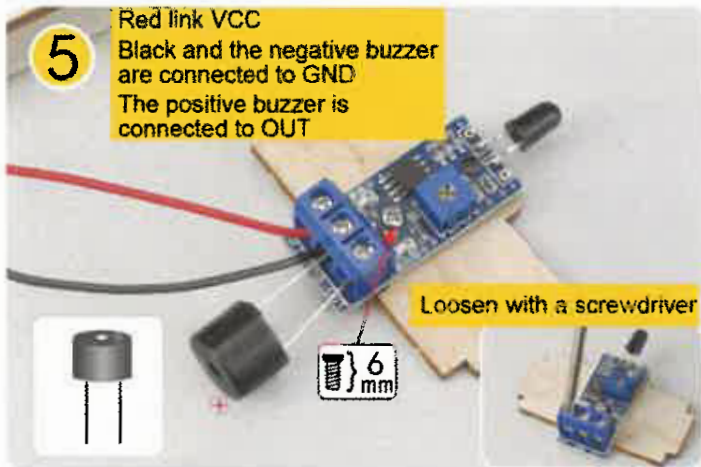

5. Fix the flame sensor module on the board with 6mm screws, screw the red wire of the battery box into the VCC, and insert the black wire and the negative terminal of the buzzer into the GND. Screw the positive end of the chirper into OUT

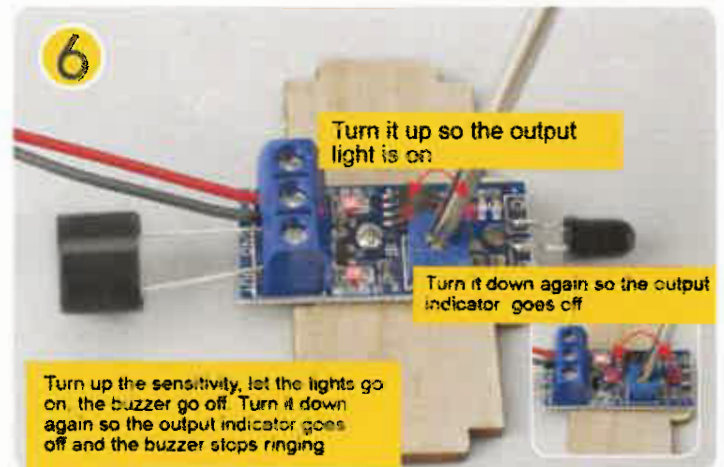

6. Install the battery, debug sensitivity

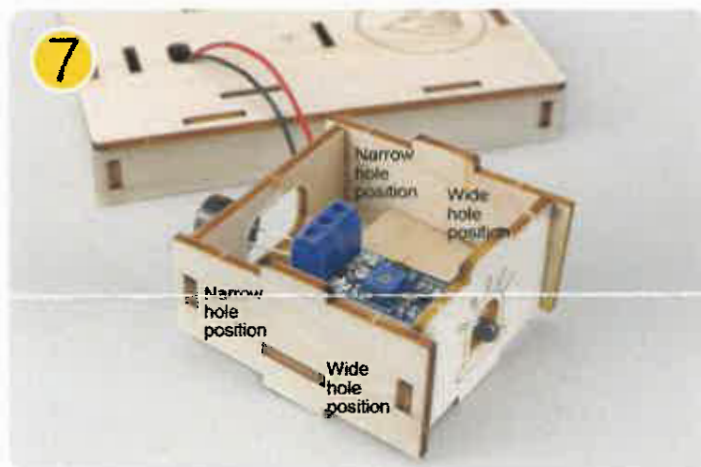

7. Assemble the alarm desk.

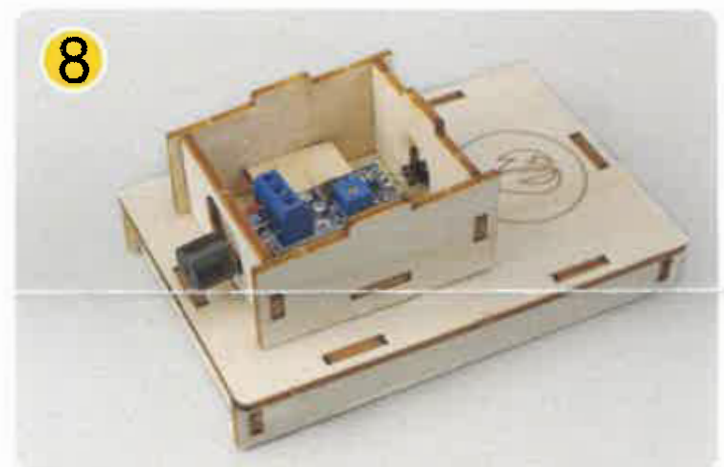

8. Fix the alarm desk on the baseplate.



9. Close the top cover.

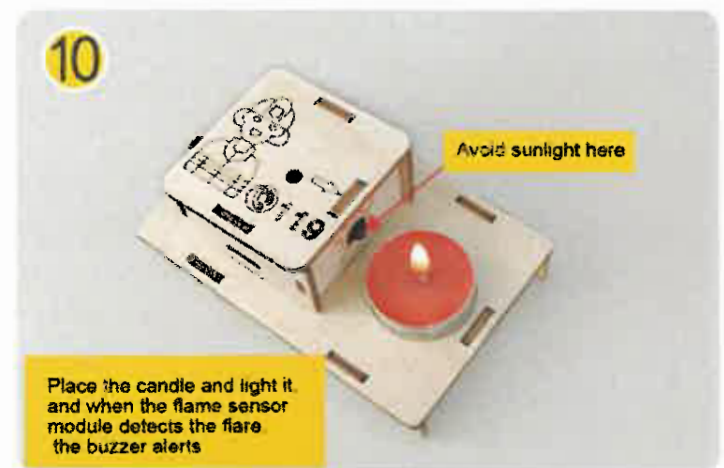

10. Place candles and burn, test! Be safe when using lighters or matches to start fires! If the results are not satisfactory, follow the debugging method in step 6