

Top View of Assembly

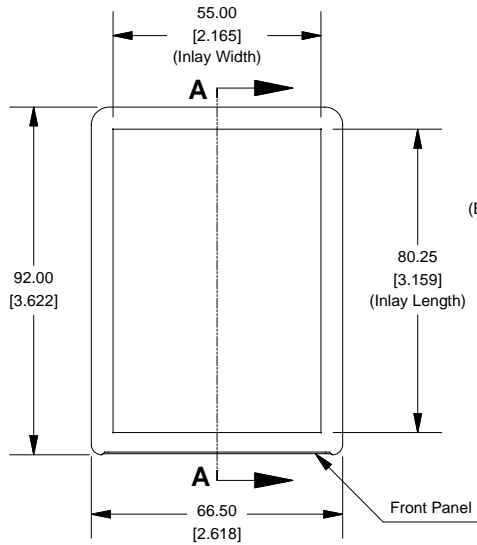

SECTION A-A (Side View Inside Assembly)

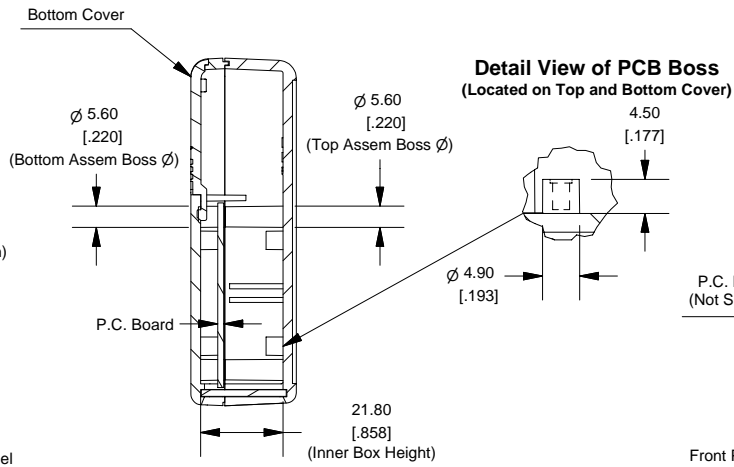

Hand Held Instrument (1593P)

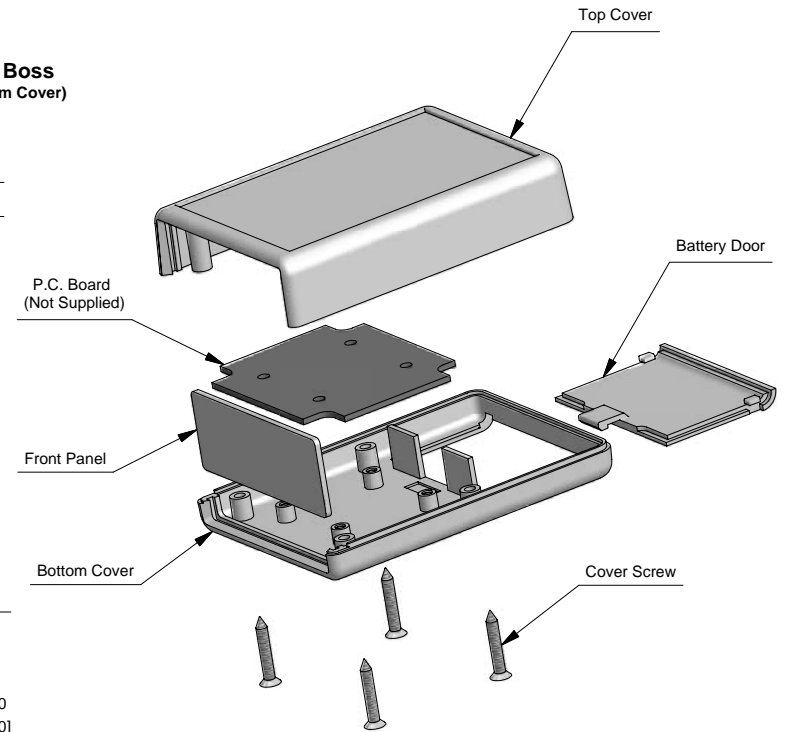

NOTE
 Purchased assembly includes top and bottom cover, front panel (plastic), battery door and 4 cover screws.

End View of Assembly

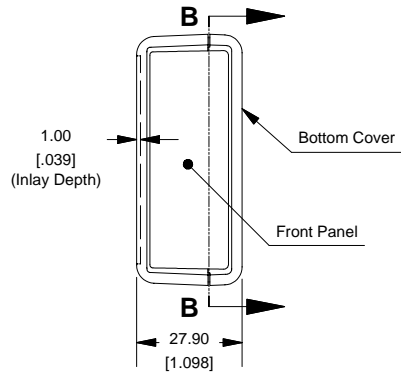

SECTION B-B (Inside of Bottom Cover)

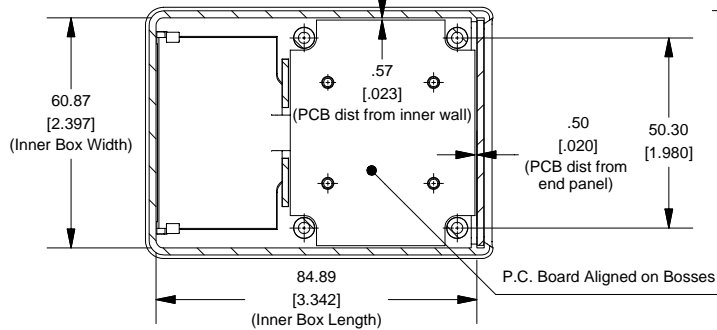

Maximum P.C. Board Size

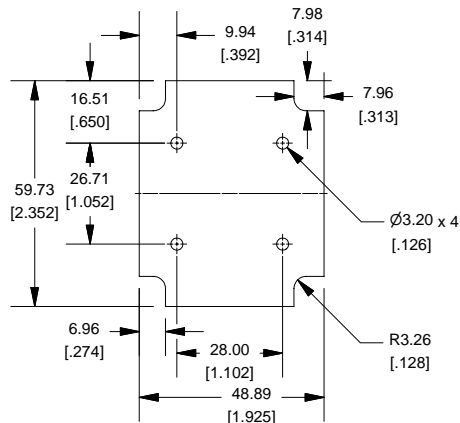

Front/Rear Panel (Dashed Line Indicates Viewing Area)

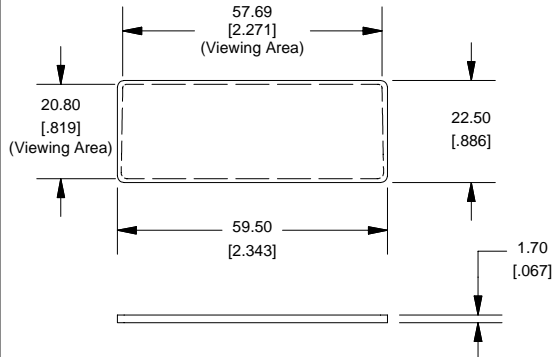

PART NUMBERS	
1593P Enclosure	
Black Enclosure	1593PBK
Grey Enclosure	1593PGY
ACCESSORIES	
Cover Screws (Pkg 100)	1593QS100
#4 x 3/4" self-tapping oval head (19.1mm)	1593ATS100 (Pkg 50)
P.C. Board Screws	1593ATS100 (Pkg 100)
#4 x 1/4" self-tapping (6.4mm)	1599CLIP (Black)
Belt or Pocket Clip	1599CLIPGY (Grey)
Infrared Panels (Pkg 10)	1593PIR10
Battery Holder Kit for:	
1 AA Cell	BH1AAW KIT
2 AA Cells	BH2AAW KIT
1 AAA Cell	BH1AAA W KIT
2 AAA Cells	BH2AAA W KIT
3 AAA Cells	BH3AAA W KIT
4 AAA Cells	BH4AAA W KIT
1 - 9V Cell	BS61KIT

