

SurgeCorp

16A Surge Plugs

Features

- High surge handling capability
- Economical secondary protection
- Thermal and overcurrent fusing
- Visual fault indication
- Differential and common mode protection

Surge plugs are used for the secondary protection of computers, video equipment, TV, alarms and other electronic equipment. They are available in the normal 16A round pin.

These plugs are fitted with an over current and thermal fuse. In the rare event of varistor failure, the varistors are disconnected from the mains supply, preventing any dangerous temperature rise. The fault indication LED which is normally lit will go OFF to indicate the faulty protection has been disconnected. Mains power will still be available to the unprotected equipment.

12-S0003

rev1



*Specifications subject to change without prior notice due to continuous improvements

Specifications	
Power Surge Protection	
Nom. Input Voltage	230VAC 50Hz
Max. Continuous Current	16A
Max. Discharge Current	8kA L-N, L-E, N-E (8/20us)
Residual Voltage	<900V
Response Time	<25ns
Input Connectors	16A 3Pin Plug
Output Connectors	16A 3Pin & 2Pin Socket

Other	
Status indication	See Fig A
Temperature Range	-20°C to +70°C
Standard Compliance	SANS 164, SANS 61643-1
Dimensions	47.5x46x43.8mm
Weight	0.07kg

Dimensions

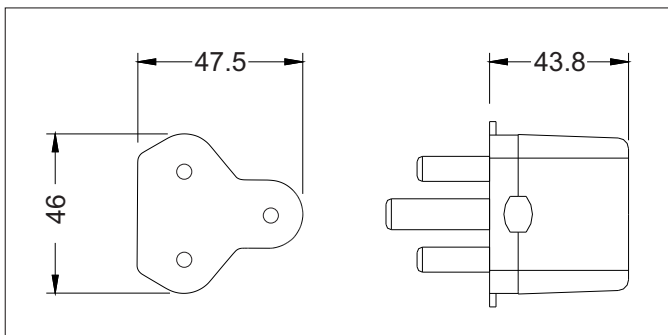
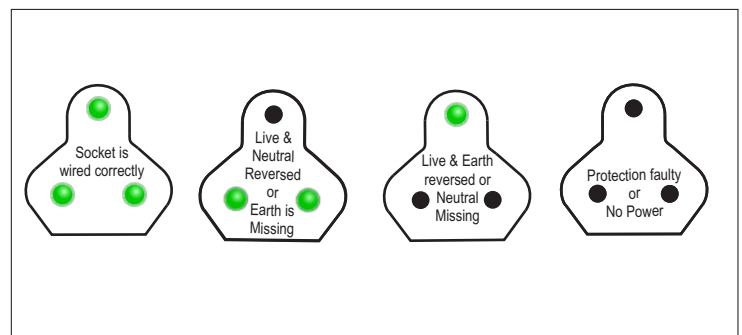

Fig A



Designed and Manufactured by:

Clearline Protection Systems (Pty) Ltd

385 Roan Crescent Corporate Park North, Old Pta Road,
Midrand, South Africa
P.O. Box 5985, Halfway House, 1685
Tel: +27 (0) 11 848-1100
Fax: +27 (0) 11 314-3880
E-mail: info@clearline.co.za
www.clearline.co.za

