



TRUERMS



AC DIGITAL CLAMP METER K2007R

- Safety tear drop jaw
- Ergonomically over molded body gives convenient one-hand operation
- Large easy-to-read display with 0.1 A resolution
- Accurate reading with True RMS 600/1000A auto-ranging
- Full covered Ø33mm Tear Drop shaped jaw
- Safety standard IEC 61010-1 CAT IV 300V/ CAT III 600V



Tear drop jaws



Data Hold



Cable (mm)



Resistance



AC
A



Continuity



AC/DC
VOLTAGE

MAJOR TECH
(PTY) LTD

T9 Industrial Village, 7 Sam Green Road, Tunney Ext. 9, Elandsfontein, South Africa
Telephone: +27 11 872 5500 Sales Facsimile: +27 11 822 2806 Admin Facsimile: +27 11 822 1411
E-mail: sales@major-tech.com



K2007R Specifications

AC A	600.0/1000A (Auto-ranging) ±1.5%rdg±4dgt [45 - 65Hz] ±2.0%rdg±4dgt [40 - 400]
AC V	600.0V ±1.2%rdg±3dgt [45 - 65Hz] ±1.5%rdg±4dgt [40 - 400]
DC V	600.0V ±1.2%rdg±3dgt
Ω	600.0Ω/6.000kΩ (Auto-ranging) ±1.3%rdg±5dgt (600Ω) ±2.0%rdg±3dgt (6.000kΩ)
Continuity Buzzer	600Ω (Buzzer sounds below 90Ω)
Conductor Size	Ø33mm max.
Applicable Standards	IEC 61010-1 CAT IV 300V, CAT III 600V Pollution degree 2 IEC 61010-031, IEC 61010-2-032, IEC 61010-2-033, IEC 61326-2-2, IEC 60529, EN 50581 (RoHS)
Power Source	R03/LR03 (AAA)(1.5V)x2
Continuous Measuring Time	Approx. 170 hours (when R03 is used) (Auto power save: approx.10 minutes)
Dimensions/ Weight	204(L) x 81(W) x 36(D)mm/ 220g Approx. (Including batteries)
Accessories	7066A (Test leads), 9079 (Carrying case), R03(AAA) x 2
Optional	8008 (Multi-tran)

True RMS function for accurate readings also in presence of modern loads such as LED lamps, motor inverters, PCs, TVs, Air conditioners, ect.

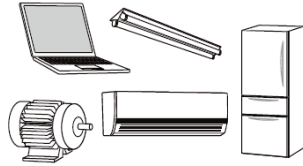

Waveform	True RMS type	Averaging value type
	✓ Correct reading	✓ Correct reading
	✓ Correct reading	Higher reading
	✓ Correct reading	Lower reading
	✓ Correct reading	Lower reading



A Current Measurement

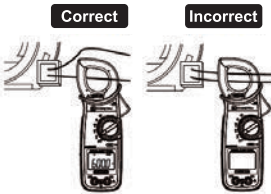

V Voltage Measurement

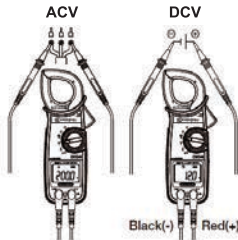

Ω Resistance Measurement



Continuity Measurement



Safety Warnings:

Please read the "Safety Warnings" in the instruction manual supplied with the instrument thoroughly and completely for correct use. Failure to follow the safety rules can cause fire, trouble, electrical shock, etc. Therefore, make sure to operate the instrument on a correct power supply and voltage rating marked on each instrument.