

MK9SST - Stainless Steel Tensioning Tool

- For stainless steel cable ties only
- Tensioning tool for heavy duty production work
- The MK9SST can be used for MBT8, MBT14, MBT20 and MBT27 Series cable ties
- Maximum width of tie: 4.6 - 13mm
- Dimensions (mm): 190 (L) x 150 (H) x 40 (W)
- Weight: 0.6 Kg



Stainless Steel Cable Tie Tensioned/Cut/No sharp edges

HT338 - Budget Stainless Steel Tensioning Tool

- Fastens and automatically cut ties with adjustable bundling pressure
- Tension adjusting indicator
- For cable tie thickness up to 0.3mm. Width up to 7.9mm
- Suitable for HellermannTyton MBT cable ties MBT8, MBT14, MBT20 and MBT27



Stainless Steel Cable Tie Tensioned/Cut/No sharp edges

Miscellaneous

Heat Guns

HG2120E - Professional Steinel Heat Gun

- Output: 2200W
- Operation hours: 750
- Temperature rating 80°C - 630°C
- Temperature Indication: By thumbwheel, infinitely variable (indicated on thumbwheel in 9 steps)
- Temperature adjustments: Manual infinitely variable temperature adjustment
- Airflow rate: 150-500l/min
- Heating element: Ceramic heating element
- Thermal cutout
- Hanging ring
- Protection class (without earth terminal): II
- Dimensions: 253 (L) x 86.5 (W) x 200mm (H)
- Power supply: 220-230V
- Weight: 0,67kg



Optional Accessories

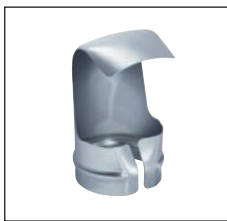

- NOZREF**
Reflector Nozzle
- Perfect for soldering pipes, fitting shrink tubing, thawing frozen pipes and bending pipes



- NOZSUR50**
50mm Surface Nozzle
- Evenly spreads air over a wide area. Ideal for evenly drying filler or stripping paint and removing films



- NOZRED9**
9mm Reduction Nozzle
- Delivers hot air with pinpoint precision for desoldering and welding plastics with welding nozzle



- | | |
|----------------|----------------|
| • Garages | • Decorators |
| • Car Wrappers | • Electricians |
| • Roofing | • Sign Makers |
| • Floor Layers | |

- | | |
|---------------------|------------------|
| • Packaging | • Aviation |
| • Electronics | • Automotive |
| • Mechanical | • Cable Assembly |
| • Tank Construction | |