

Professional CCTV System

IR CCTV Bullet Camera

User Manual



Please Read This User Guide Carefully Before Use.



Warning



To prevent fire or electric shock hazardous, do not expose the unit to rain or moisture. And only use the power supply specified for the unit.



This symbol alerts the user to presence of importance operating and maintenance issues according to the manual



CONNECTING CCTV SYSTEM

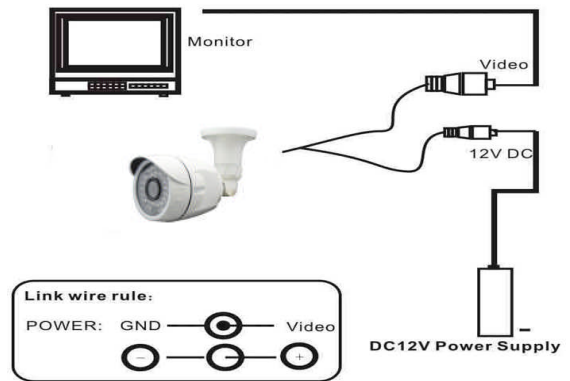

Specification

| | |
|-----------------------|--------------------------------------|
| Model | XY-AHD 36BF 1.0MP 4 IN 1 |
| System | PAL |
| Image Sensor | HDI8901 + AR0141 |
| Picture Elements | PAL:1280(H)*720(V) |
| Horizontal Recolution | 1.0 Megapixel |
| Video OutPut | 1.0Vp-p Composite Output (75Ω / BNC) |
| S/N Ratio | ≥48dB |
| Min.Illumination | 0LUX(IR ON) |
| Electronic Shutter | 1/50(1/60)S~1/100,000S |
| White Balance | Auto |
| Gamma Ratio | >0.45 |
| Lens Mount | 3.6mm MP lens |
| Operating Temp. | -10℃ ~ +50℃ |
| Humidity | 0 to 95%RH(non-condensing) |
| Power/Current | DC 12V |
| Sync System | 2:1 Interlace internal Sync. |
| IR Project Distance | 20M |
| IR Status | On |
| Outdoor/Indoor | Outdoor |

Packing list

| Name | Model | Number |
|---------------------|--------------------------|--------|
| Digital CCTV Camera | XY-AHD 36BF 1.0MP 4 IN 1 | 1 |
| User Manual | XY-AHD 36BF 1.0MP 4 IN 1 | 1 |

Installation Notice

1. Do not attempt to open the cover unless you are authorized to do so.
2. Handle with care.
3. Do not expose the camera to eroding Environment.
4. Pay attention to keep the surface of the lens clean. The clearness of the image can be damaged if the surface is scratched
5. Do not expose the camera to moisture exceed 85% for a long time.
6. Please do not use strong corrosive cleaner when clean the surface of the camera.
7. Avoid focusing on the sun or highlight directly. Avoid working in spotlight or highlight environment.
8. Set the power voltage according to the Manual.
9. Use the camera within the temperature between -10 ~+50.



Notes:

- *Please note the camera's operating temperature and its using environment. Avoid using the camera at too high or too low temperatures.
- *Never make the camera face the sun or bright object. otherwise will damage the CCD.
- *Dont mount the camera near by the radiator or heater.