



2 TECHNICAL PARAMETERS

Resolution: 720P □ 1080P □
 Viewing angle: 135-165 degrees
 WIFI: Support 802.11b/g/n
 Audio: two-way audio, echo cancellation
 Video: TF card recording
 Storage: support 128G Max
 Battery: 2pcs 18650 batteries
 Power consumption: standby current 200uA
 operating current 180mA

1 OWNLOAD APP

1. Download "Onecam" via "Google Play" / "Apple store"
 OR Scan below QR code download "Onecam" APP
2. then register and log in to the app

to receive all notifications, please allow all notification rights



Onecam APP

2 SETUP DEVICE

log in to the app, Click on the "+" of the app and select Add manually to proceed to the next step.

*to receive all notifications, please allow all notification rights!

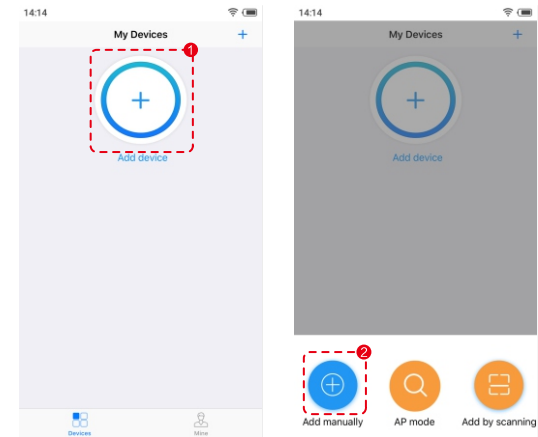

The device is powered on. Wait for the device indicator to be steady red. (If the indicator is not steady red, please wake up the device by pressing the reset button. When the indicator is steady red, release the reset button.) Click "Next step"; follow the instructions of the APP until the status of the light changes to blue light flashing, indicating that the device is successfully connected to the network and can be used.

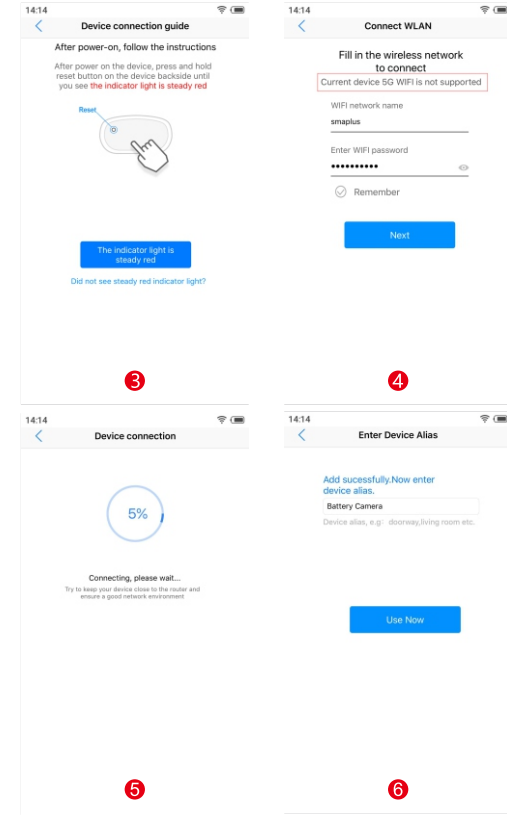

3 VIDEO QUERY

Click the "File" icon to view the video in the TF card (Note: the device needs to insert the TF card, turn on the alarm detection and record the video before you can query the video file)

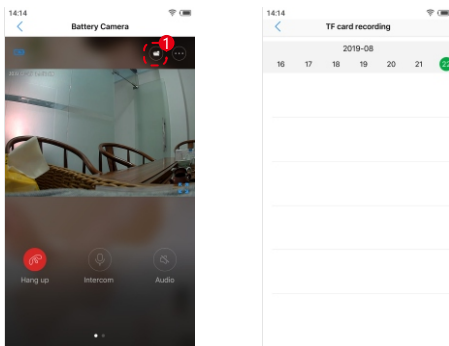

4 Cloud storage video

Click the cloud storage feature icon on the device list page, Enter the cloud storage video query and purchase page.

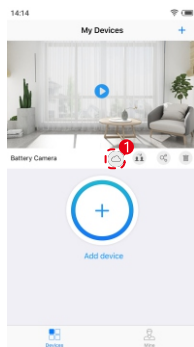

5 DEVICE SHARING

Click the "Share" icon, enter "Share Management", click the "Share" button, your friends can click the "+" of the app to select "Scan Add" to scan the QR code of the sharing device, then share Your device.

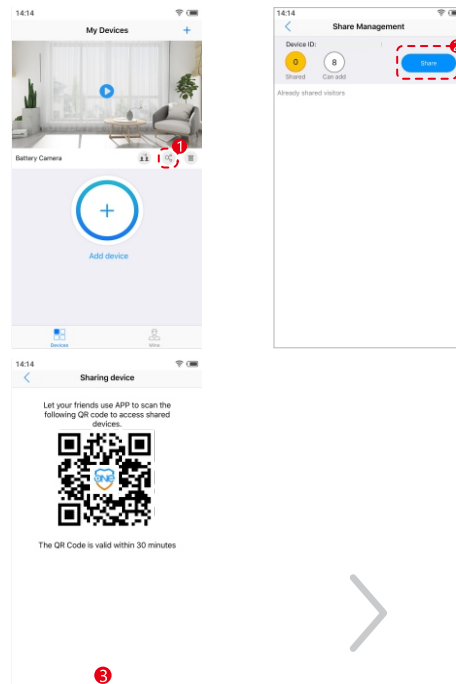

6 AP mode (Video doorbell does not support this function)

Open the APP, click "Add Device" to select "AP Mode", enter the hotspot connection interface, click "Next" to the mobile phone WiFi selection interface; find WiFi named " Onecam-xxxx" Hotspot to connect (WiFi password: 123456789); After successful connection, return to APP.

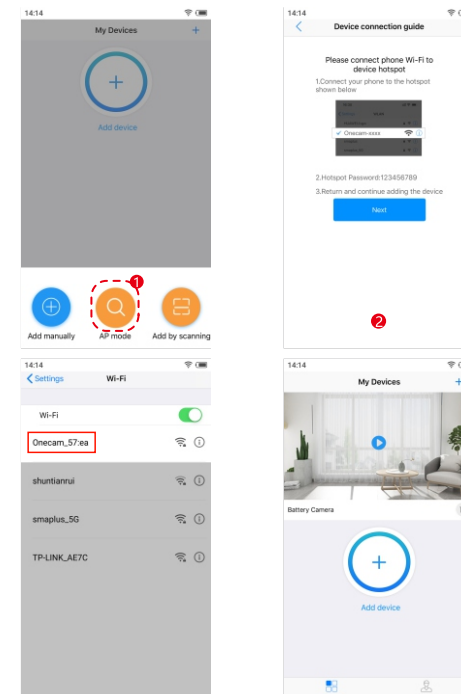

FAQ

APP CAN'T ADD DEVICE?

- 1 Is the router connected to the device able to access the Internet?
- 2 Are the WIFI name and password correct, and if the device enters the distribution network mode (the device enters the distribution mode when the red light is steady on)

DEVICE ONLINE, APP DOES NOT RECEIVE PUSH MESSAGES?

- 1 The mobile phone opens "self-starting" to the APP, and the "application permission" enables the notification function.
- 2 Huawei / mi [Notification and Status Bar] inside the APP Allow [Allow Notification], the notification bar will not have any reminders.