

■ Security Overview

Before use, please understand the following safety precautions to prevent product damage.

- Use the correct power supply, specifications: 12V 1A or more.
- Use professional equipment to install, to avoid wiring errors leading to host damage.
- Do not squeeze the touch keyboard and display area.
- Do not use in a humid environment.
- Do not operate in flammable or explosive atmospheres.
- Keep the product surface clean and dry.
- Maintain adequate ventilation.

CATALOG

I、 Product Introduction	1
II、 Product Knowledge	2
III、 Installation	4
IV、 Preparation Before Use	5
V、 Daily Use & Maintenance	7
VI、 Product Introduction	10
VII、 System Troubleshooting	17
VIII、 Main Technical Parameters	17
IX、 Packing List	18
X、 Storage&Transportation	18

I Product Introduction

WiFi + GSM + RFID intelligent alarm system is a powerful alarm system with a combination of host and accessories. Host is the core of the system, accessories will send the signal to the host when being triggered, then the host makes an alarm sound to frighten intruders, and to alarm through the network or SIM card. Host can be remotely controlled, and monitoring, intercom and other operations.

Features

- WiFi (IEEE 802.11b standard) and GSM dual-network alarm technology.
- LCD display and capacitive touch buttons, easy and convenient operation.
- Can learn 8 wireless remote controllers and 10 RFID cards.
- 10 wireless zones (80 detectors in total) and 2 wired zones.
- Each zone can be independently armed, support accessories alarm / low voltage alarm / tamper alarm and other SMS tips.
- Can preset 6 groups of alarm calls, 3 groups of SMS alarms.
- Support mobile phone APP (Android and IOS) operation.
- With one-way relay alarm linkage output, 4-way wireless home appliances control.
- Timing arm / disarm, delay arm, delay alarm, alarm time can be reset.
- Remote arm, disarm, monitor, intercom and other functions.
- 30 alarm records can be queried.
- Built-in high-capacity lithium battery, can also work properly when power off.

II Product Knowledge

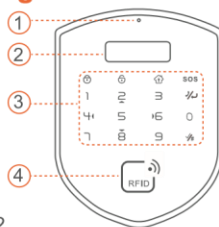
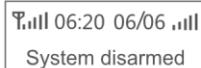

Fig (1)

- ① Microphone: Intercom.
 - ② Display: Resolution: 128X32
- Host Interface Description



Note:  GSM Signal: no flicker signal card / signal strength.

--/-- --:-- Date&Time:Hour-Day-Month

 WiFi signal: indicating the host WIFI signal strength, flashing means not connected to the service cloud;

 Increment indicates SmartLink mode;

 Decrement indicates SoftAP mode;

 Indicates only connecting to LAN.

③ Touch Keypad Area

 Away Arm: The light will be normally on if the host in the arm state.

 Home arm: The light will be normally on if the host in the home arm state.

 Disarm: Operation password (default 123456) + Disarm key. The light will be normally on if the host in the disarm state.

SOSkey/Confirm key/# key: Standby, long press this button for emergency call alarm.

 Clear key / Return key: disarm state input telephone number, press this button to call, press to check alarm record.

 Key words /# Confirm key: short press 0 to confirm key to enter SOFTAP mode.

 On behalf of the up and down, left and right keys.

④ RFID Card Area: in the standby mode, short swipe card to arm the system, long swipe

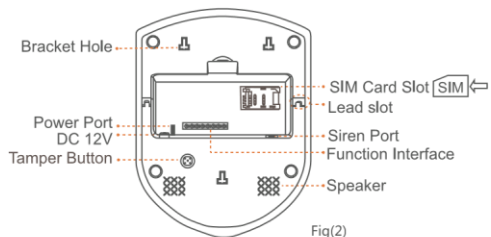

Fig(2)

Host function interface description:

1	NC	Relay output normal closed (when dosed,alarm stop)
2	COM	Relay output common port
3	NO	Relay output normal open (when open,alarm stop)
4	Z1	Wired zone 1 input, available for both NO / NC detectors.
5	GND	Ground
6	Z2	Wired zone 2 input, available for both NO / NC detectors.
7	GND	Negative
8	+12V	Positive (uncontrolled)

Host function interface diagram:

1.Wired detectors connection for example,wired PIR detector with 6 ports :

Tamper output → Z1 GND
 Alarm output → Z2 GND
 +12V GND → +12V GND

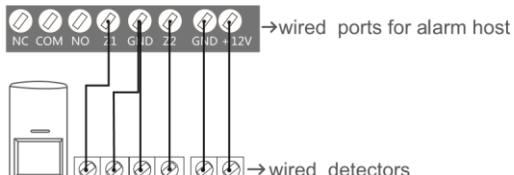

2. Electronic control lock: Users need to connect one end of the electric lock to NC and the other end to COM.

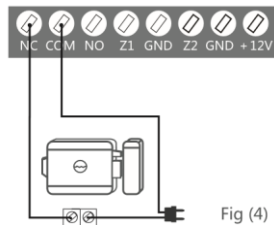

Fig (4)

Installation

The host should be installed in the center of the alarm place for the best receiving result from all wireless detectors. Note that the host installation should be as far as possible away from large-scale metal objects or household appliances with high-frequency interference, while keep away from the reinforced concrete walls and fire doors and other shielding materials.

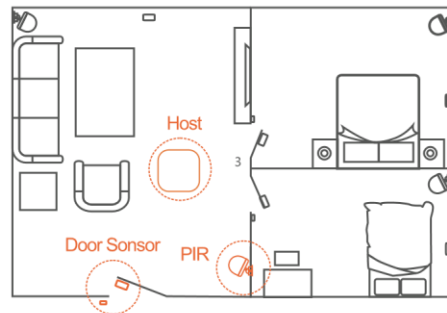

Fig (5)

Note: • Host is better Installed in the center of the defense area.

- Door sensor can be installed on the doors, windows, drawers.etc.
- PIR detector has 120 degree sector region, canbe installed 2 meters above the ground, where human active and easily being detected.

IV Preparation Before Use

1. Right to start the host is very important, it will be related to the normal operation of the host and service life.

GSM:

- 1 Must install the SIM card when the host is powered off.
- 2 Connect to the power, turn on the main power switch, enter the initial state.
- 3 Wait for the host to register the network, after registered successfully, the GSM signal icon on the display always shows.
- 4 Wait for the host time information to be updated and start up. (if not updated for a long time, then reboot)

WIFI Pairing:

- 1 The first step: download the mobile APP, register with an Email account, login the account, click the plus button on top right corner
- 2 Plese make sure that the cell-phone is connected to the WIFI network
- 3 Select to enter SmartLink mode (WIFI connection mode), enter the WIFI password.
- 4 Long press "0" key , the host beep twice, the signal on the top right corner of home screen become stronger, indicating it's searching network, Click confirm on the mobile phone APP to complete the matching host. The signal tower changing indicating the signal strength of WIFI connection, the host long "Beep" sound, signal tower become weaker showing entering SoftAP mode (WIFI connection mode).

2.Download App

Android: Go to Google to search "S-HOME" to download APP.

IOS: Go to APP Store to Search "S-HOME" to download APP.

You can also scan the two-dimensional code to download and install.



Note: Only applies to Android version 4.0 and above
(Please use the mobile browser to scan)



Note: Only Applies to IOS version 8.0 or above

3. App Operation

Default Access Password: 123456

Default Administrator password : 123123

1.User login



Fig (6)

2.Enter The Device List

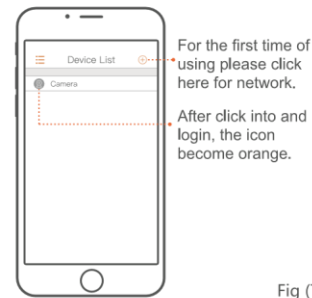

Fig (7)

For the first time of using, please click here

3. Get Help

When the host is connected to the network, it can scan the QR code (in Device Sharing of Device Management) and add it directly to the host.

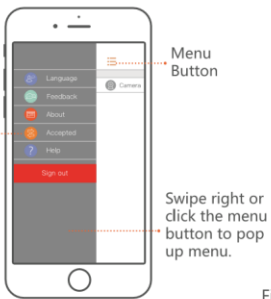

Fig (8)

4. Control Interface

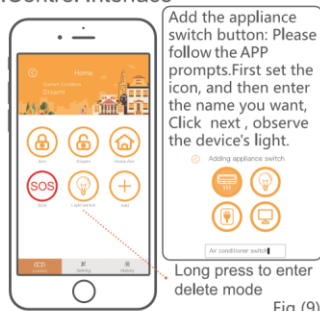

Fig (9)

▼ Daily Use & Maintenance

1. Remote control for fast Arm & Disarm: Press the button on the remote control, the host will enter the state corresponding to the button.

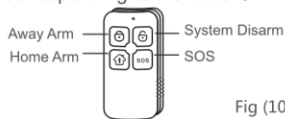

Fig (10)

2. Phone connection operation

Once the host alarms, siren immediately issued a warning sound; at the same time automatically dial the default phone (cell-phone) for voice alarm. When the call is not answered, the host will automatically dial the next phone number, looping through all the preset phone numbers three times. If the dialed telephone has answered and turned off the siren, the telephone handset immediately transmits an alarm message and repeats the alarm zone number. At this point, press the phone (cell-phone) keypad, you can achieve

Direct hand up: The host loops all three times for all calls.

Press [1 #]: the host stops the alarm, and arm; host no longer call.

Press [2 #]: the host stops the alarm, and disarm; host no longer call.

Press [3 #]: the host will turn off the siren and to monitor the spot for 60s. to check if there is abnormal sound or thieves invasion at home.

Press [4 #]: start the intercom function for 60s, then exit the intercom until the next command.

Note: When the system receives the wrong instruction, the system will play the alarm message, and will turn off the intercom, for intercom, please re-enter [4 #].

3. Remotely control

By phone (cell-phone) to dial the phone number corresponding to the alarm host SIM card, the phone handset to hear long "beep". Meanwhile, Input the password, If the password is right, the receiver will hear the "beep". If the password is right, the receiver will hear the "beep""beep""beep""beep", Please input the password again. (The system will hang up the phone when the password is wrong for three times.) After entering the remotely control operation, users can remotely operate the host through the telephone keypad.

Press [1 #]: to arm the host.

Press [2 #]: to disarm the host.

Press [3 #]: Live monitor, monitor the home if there is abnormal sound or thieves invasion.

Press [4 #]: start the intercom function, until the next command to exit the intercom.

4. SMS control

Send text messages to control the host, control password is 123456 #1 # for Arming; 123456 # for 2 # disarm; 123456 # 3 # for home arm.

5. Check the alarm records

Host can save 30 alarm records. When the alarm record exceeds 30, the oldest alarm record will be deleted automatically. alarm records checking method: In the disarmed state, short press [📞] to enter the alarm record checking. Press 4 or 6 to scroll through

if there is an alarm situation, the system will automatically exit the checking state, into the alarm state. The diagram is as follows.

10/20 16:08 01
Panel SOS Alarm

Fig (11)

6.Remote checking of host status:

The user can check the current status of the host anytime and anywhere via SMS commands. Method: send 123456 # 61 # to the SIM card number within the host. Reply message will be:

-->The system status: disarm

-->The system status: arm

-->The system status: home arm

7. Restore the factory password setting

When the user forgets the password, you can enter the command: 95175308246 in the standby status (non-alarm state, non-remote control state) of the system, then press [OK]. The host displays: "Restore default password, please wait". Graphic as follows:

📶 06:20 06/06 📶
95175308246 → Return to default password

Fig (12)

8.System check

Although the alarm system is used every day, it must also be regularly maintained and tested, in order to ensure the alarm system is stable, reliable and of safe operation. usually, the alarm host should have a comprehensive detection in every three months, the detector should be tested in every month, at least once every three months.

Host detection:

- ① Whether the host could normally arm and disarm
- ② Whether host could normally dial out in GSM network when alarm.

- ④ Whether the host could normally receive the detector signal or back-up battery and whether the backup battery is normal.

Detectors/Sensors detection:

- ① Manually trigger the detector, check whether the alarm is normal.
- ② Check the battery of all detectors to see if the voltage is low.
- ③ Test the launch of the wireless detector to see if it can communicate with the host.

VI Product Introduction

- Enter The System

Default Access Password: 123456

Default Administrator password : 123123

The above passwords are factory default and can be modified (refer to step 11 of the operation flow chart).

- Operation Flow Chart

- ① 📶 06:20 06/06 📶
System disarmed **Note:**To delete the number on the screen or return to the previous step, please press [C].

✓ Enter the password on the keyboard

- ② 📶 06:20 06/06 📶
123123

✓ +Press [OK], to enter the system settings.

- ③ Remote control
Note : APP is not supported on the code
- +Press [OK]
- Pair
Delete
- +Press [C]
- 00 000000 Trigger remote
- 00000000 Normal code
- +Press [OK] to confirm
- Serial number for the remote control position
- Subject to the number that appears in the coding
- Press any key on the remote control to send a signal

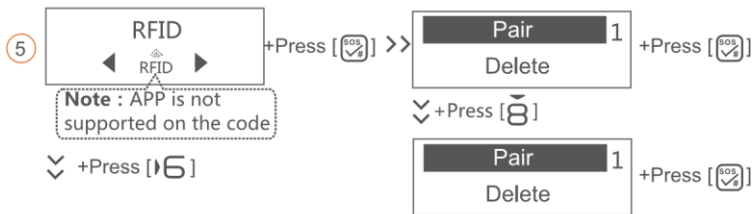
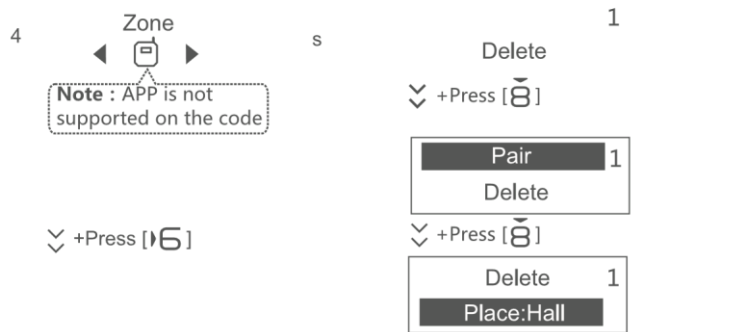

>

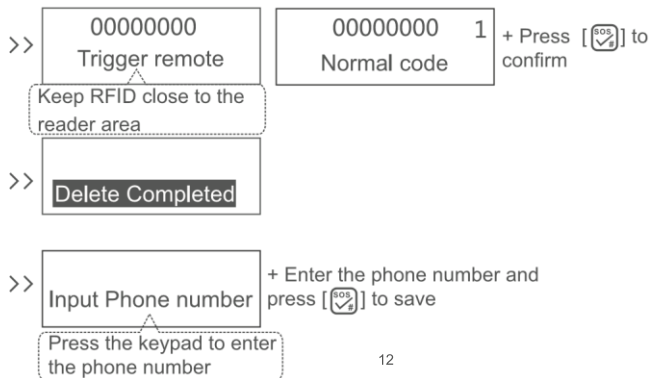
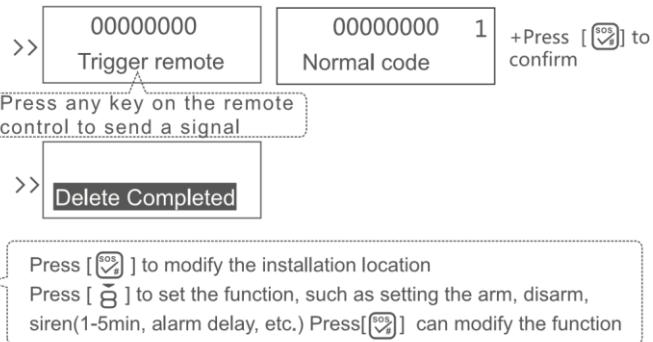

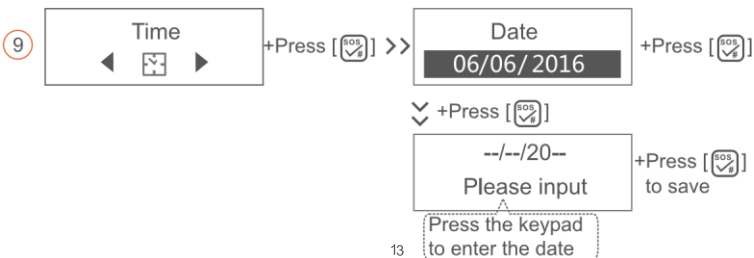
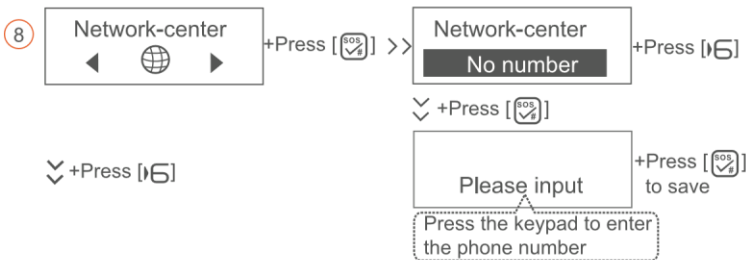
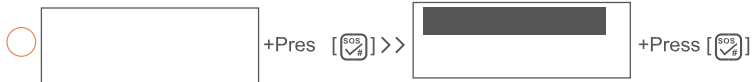

>

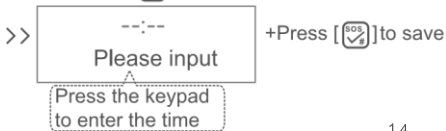
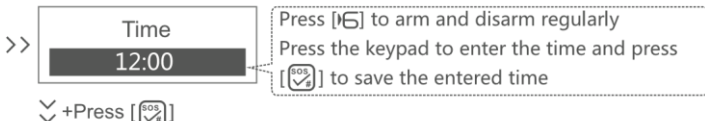
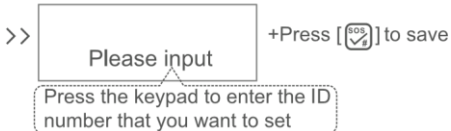
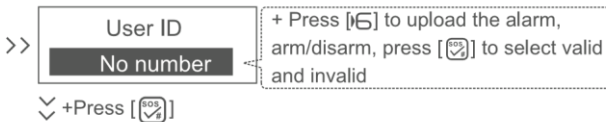
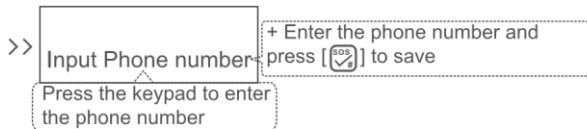

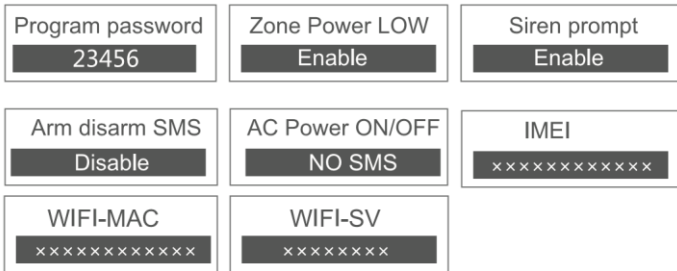
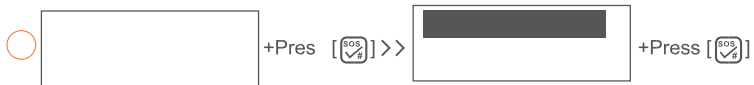

>



Arming delay time range "01-99", "00" is off

Alarm delay time range "01-99", "00" is off



VI System Troubleshooting

Symptom	Possible Cause	Solution
No network detected	Is the SIM card installed or not?	Reload
	Is the PIN set on the SIM card?	cancel
	Is the mounting position of strong signal enough to accept the signal?	Change the mounting place
Can not alarm	Whether coding is normal or the code is successful?	Confirm the correct code, and then re-code
	Whether the sensor is of enough power to launch?	Replace the battery
Can not dial the Phone	Is the mobile signal strong enough?	Change the place
	Is your cell-phone topped-up?	Check and prepaid the SIM card
	Check if the phone number is set correctly	Reset
Siren does not ring	Is the siren of good contact?	Examination
	Is the zone muted?	Reset
Can not be remotely controlled	Is the remote control password input correct?	The original is 123456
System false alarm	Whether paired with other detectors?	Re-code

VII Main Technical Parameters

Power supply	AC=110-240V±10% DC=12V (built-in rechargeable battery)
Standby current	< 180mA
Alarm current	<450mA
Wifi frequency range	2.412GHZ-2.484GHZ
Wifi standard	IEEE 802.11 b/g/n
Wireless reception frequency	433MHz±0.5MHz

Wireless receiving sensitivity	5mV / m
Anti-interference strength	1V/m (frequency range 20-100MHZ)
External Alarm Siren Sound Intensity	110dB
(Working Environment) Temperature	-10°C ~ +40°C
(Working Environment) Relative humidity	≤90% without condensation
Configurable Wireless Device Capacity	8 remote controls, 80 detectors, 10 RFID cards
Wireless Transmission Frequency	315MHZ/433MHZ/868MHZ
Wireless Reception Frequency	433MHZ

IX Packing List

Packing	Quantity
Host	×1
Wireless Door Sensor	×1
Wireless infrared detector	×1
Remote controls	×2
Wireless mini Siren	×1
Power adapter dC12V/1.2A	×1
Rechargeable backup battery	×1(built in)
User manual	×1

X Storage&Transportation

Storage Conditions: temperature -10°C ~ +40°C, relative humidity less than 90%, ventilation, non-corrosive objects, the standard carton, stacking layer is less than 6 layers.

Transport Conditions: stacking layers less than 6 layers, avoid shock in handling process , add other appropriate conditions are as above.

